

LANDUSE ANALYSIS

| Sl.No | Land Use | Area in Sqm | % |
|-------|-----------------|-------------|--------|
| 1 | Residential | 9189.25 | 52.80 |
| 2 | Commercial | 370.90 | 02.13 |
| 3 | Park | 912.16 | 05.25 |
| 4 | Civic Amenities | 875.60 | 5.03 |
| 5 | Road | 6053.57 | 34.79 |
| Total | | 17,401.48 | 100.00 |

DC CONVERSION ORDER NO.- ALNSR/172/MO/14-15 DATED 07-09-2015

INDEX

| Sl.No | Site Dimensionsin m | Nos |
|-------|--------------------------|-----|
| 1 | 9.14 X 12.19 | 26 |
| 2 | 9.14 X Odd | 34 |
| 3 | 9.14 x 20.29 | 05 |
| 4 | Odd | 09 |
| Total | | 74 |

GOVT OF KARNATAKA
Department Of Town and Country planning
Office of The Assistant Director of Town & Country Planning
Kolar

ಶರಣ್ಣ ಮಠು ಗುಪ್ತಾಚಾರ್ಯ
Town & Country Planning
ಕೋಲಾರ
Chk by Kolarwamyak .T.P

RESIDENTIAL LAYOUT
AT SY.NO.235 OF HUDUKULA VILLAGE, KASABA HOBLI, BANGARPET TALUK
EXTENT:- 1.74 ha (4Acres 12 Guntas)
IN FAVOUR OF: Sri. R.N.SHANMUGAM
S/O.R.K. NARAYANSWAMY

Reg No. 1002/KSP/02/2016-2016
S-CUBE consultants
GOVINDA REDDY BUILDING,
III CROSS ROAD, K.G.F.,
PH-9741 78 79 76 & 88 6 77 0 35 12

ಸದರಿ ದಿನಾಸದರ್ಶನ ಈ ಕಛೇರಿಯ ಅಧೀನ ಸಂಖ್ಯೆ:ನ.ಗ್ರಾ.ಯೋ. ಸ.ನಿ.ಕೋ:ತಾಂ.ಶಾಖೆ:6/4/ದಿನಾಸ:2015-16ನಂ:ಕ23.12.201.16 ರಲ್ಲಿನ ನಿರ್ಧನದ ಅನುಷ್ಠಾನಕ್ಕೆ ತಾಂತ್ರಿಕವಾಗಿ ಅನುಮೋದಿಸಿದೆ.

ALL DIMENSIONS ARE IN MTRS

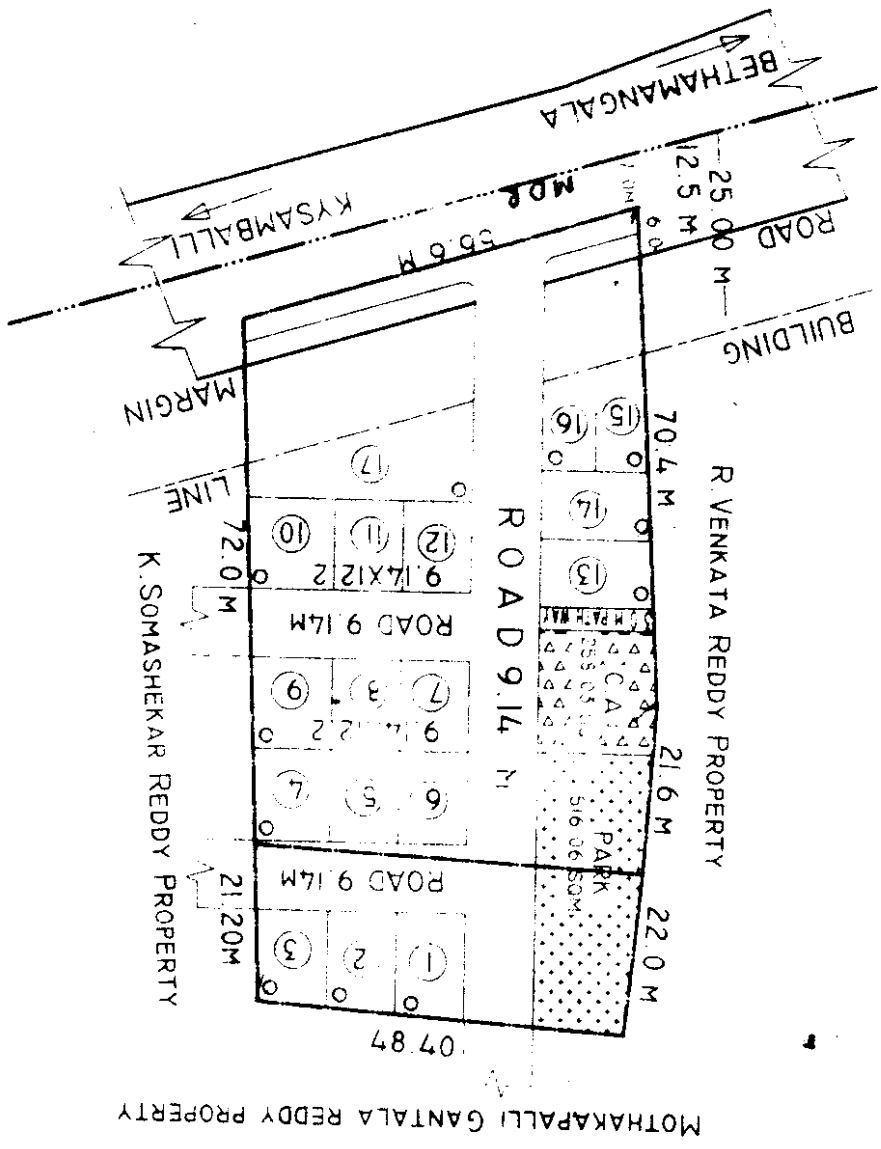

MOTHAKKAPALI GANTALA REDDY PROPERTY

ಈ ಕೆಳಕಂಡು ಚಿತ್ರಣವು ನಗರಯೋಜನೆ ಪ್ರಕಾರ | ಬಂ. ವ. ಅನುಕ್ರ. 03 | 2013-14
 ಉಂಟು 2B-11-2013ರ ಸಂಬಂಧಿಸಿದ ಗಣಿ ಮತ್ತು ಭೂ ವಿಜ್ಞಾನ ಇಲಾಖೆಯಿಂದ.

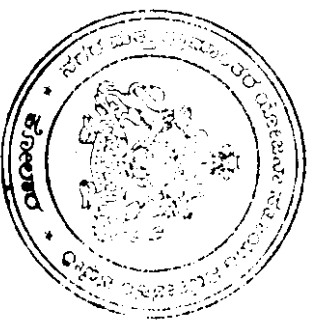

LOCATION PLAN
 HOT TO SCALE

LAYOUT BOUNDARY

LAND USE ANALYSIS

| SL | LAND USE | AREA IN SQMT | % |
|-------|---------------|--------------|--------|
| 1. | RESIDENTIAL | 2633.09 | 51.62 |
| 2. | ROAD | 1389.10 | 26.92 |
| 3. | MARGINAL AREA | 333.29 | 6.46 |
| 4. | PARK | 516.06 | 10.00 |
| 5. | C.A | 258.03 | 05.00 |
| TOTAL | | 5159.57 | 100.00 |

EXTENT AREA = 1A II G = 5159.57 SQM

SITE ANALYSIS

| SL | SITE DIMENSIONS | NOS |
|-------|-----------------|-----|
| 1. | 9.14M X 12.20 M | 06 |
| 2. | ODD | 11 |
| TOTAL | | 17 |

LAYOUT IS PREPARED AS PER DC OFFICE LETTER NO
 1 ALN SR 14/12-13, DTD 22/03/2013 FOR 1A II G
 2 ALN SR 14/12-13, DTD 22/03/2013 FOR 0A II G

GOVT OF KARNATAKA
 OFFICE OF THE ASST DIRECTOR
 DEPARTMENT OF TOWN & COUNTRY PLANNING
 KOLAR

ASST DIRECTOR

DRAWN & CHECKED BY

DATE: 28/11/13

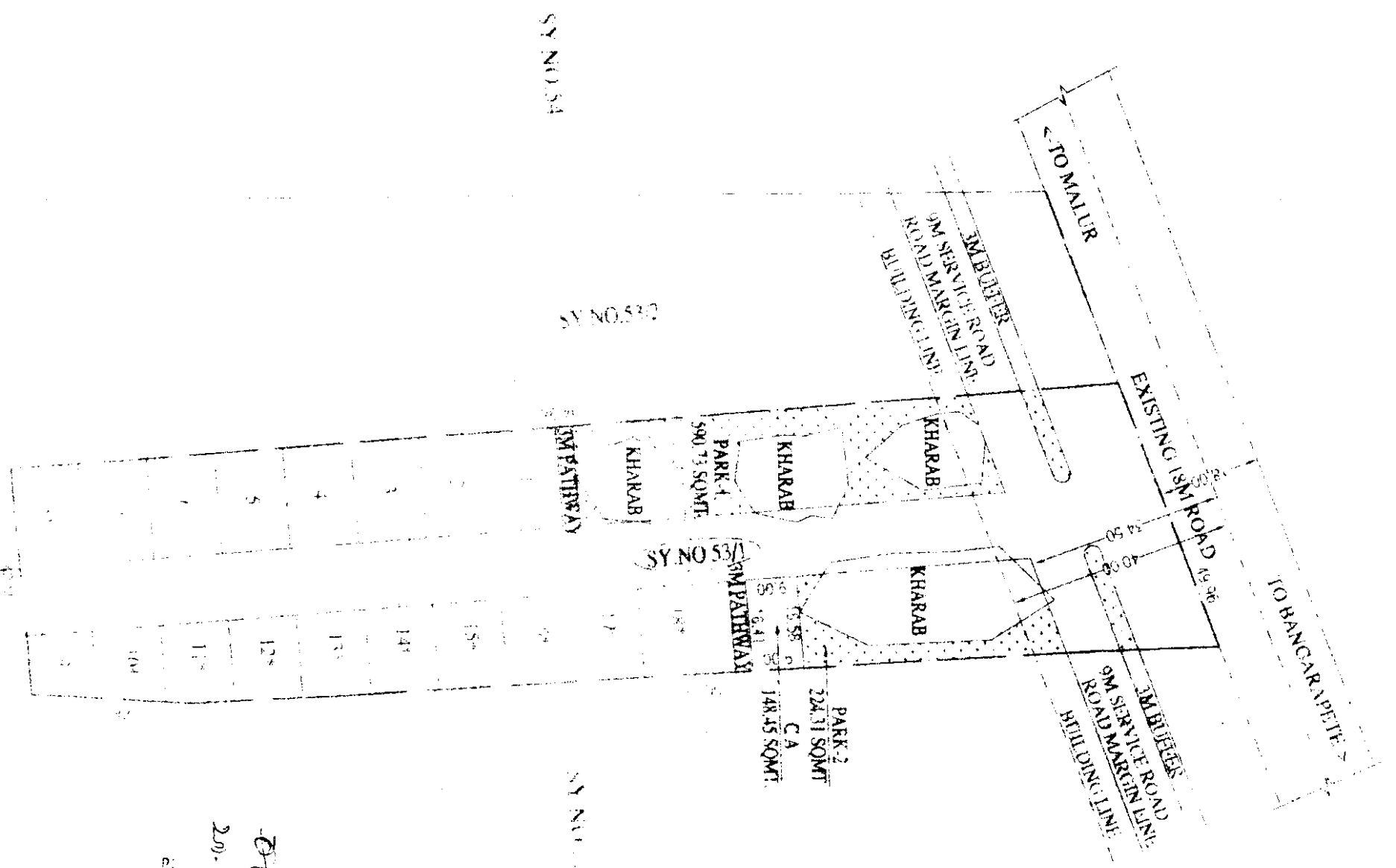

ಈ ಬಗ್ಗೆಯಲ್ಲಿ ಸರ್ಕಾರಿ ಸಹಕಾರವನ್ನು
 20. 5. 2019/08-09, 21. 16. 2019 ರಂದು
 ಪಡೆಯಿತು ಎಂದು ತಿಳಿಸಲಾಗಿದೆ.

LAYOUT BOUNDARY

| SL. NO. | LAND USE | AREA IN SQMT | % |
|---------|---------------|--------------|-------|
| 1 | RESIDENTIAL | 3539.71 | 51.4 |
| 2 | PARK & BUFFER | 925.36 | 13.4 |
| 3 | ROAD | 148.45 | 2.1 |
| 4 | ROAD | 2766.04 | 39.9 |
| TOTAL | | 6879.56 | 100.0 |

GOVT KCHARAB, BANGALUR

| SL. NO. | PROJ SIZES | NO OF PLOT |
|---------|-------------|------------|
| 1 | 11.19X18.29 | 07 |
| 2 | 4.00X18.29 | 11 |
| TOTAL | | 18 |

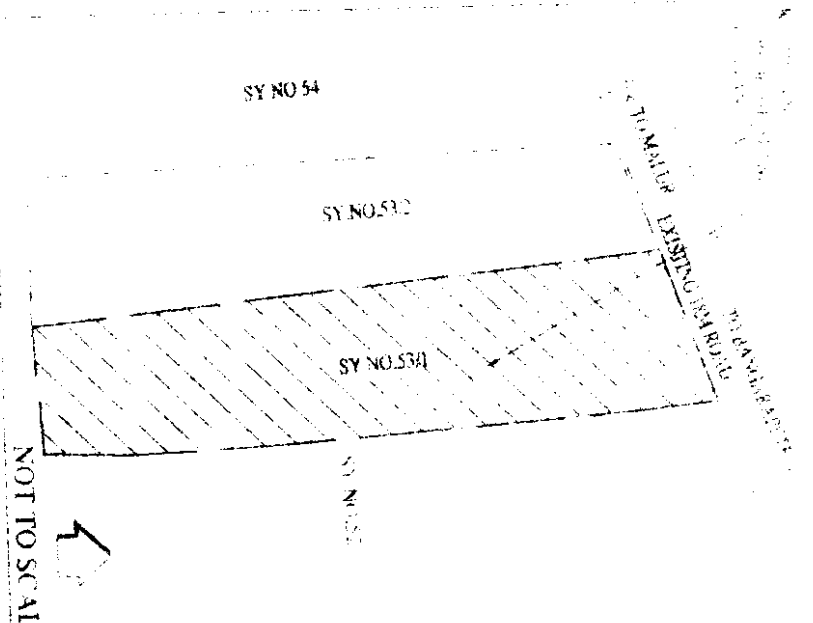

GOVT OF KARNATAKA
 TOWN PLANNING DEPARTMENT
 OFFICE OF THE ASST. DIRECTOR
 OF TOWN PLANNING KOLAR

ASST. DIR. FOR
 20/10/2019

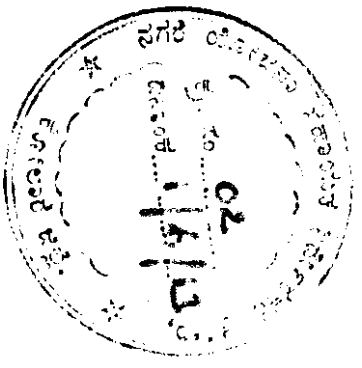
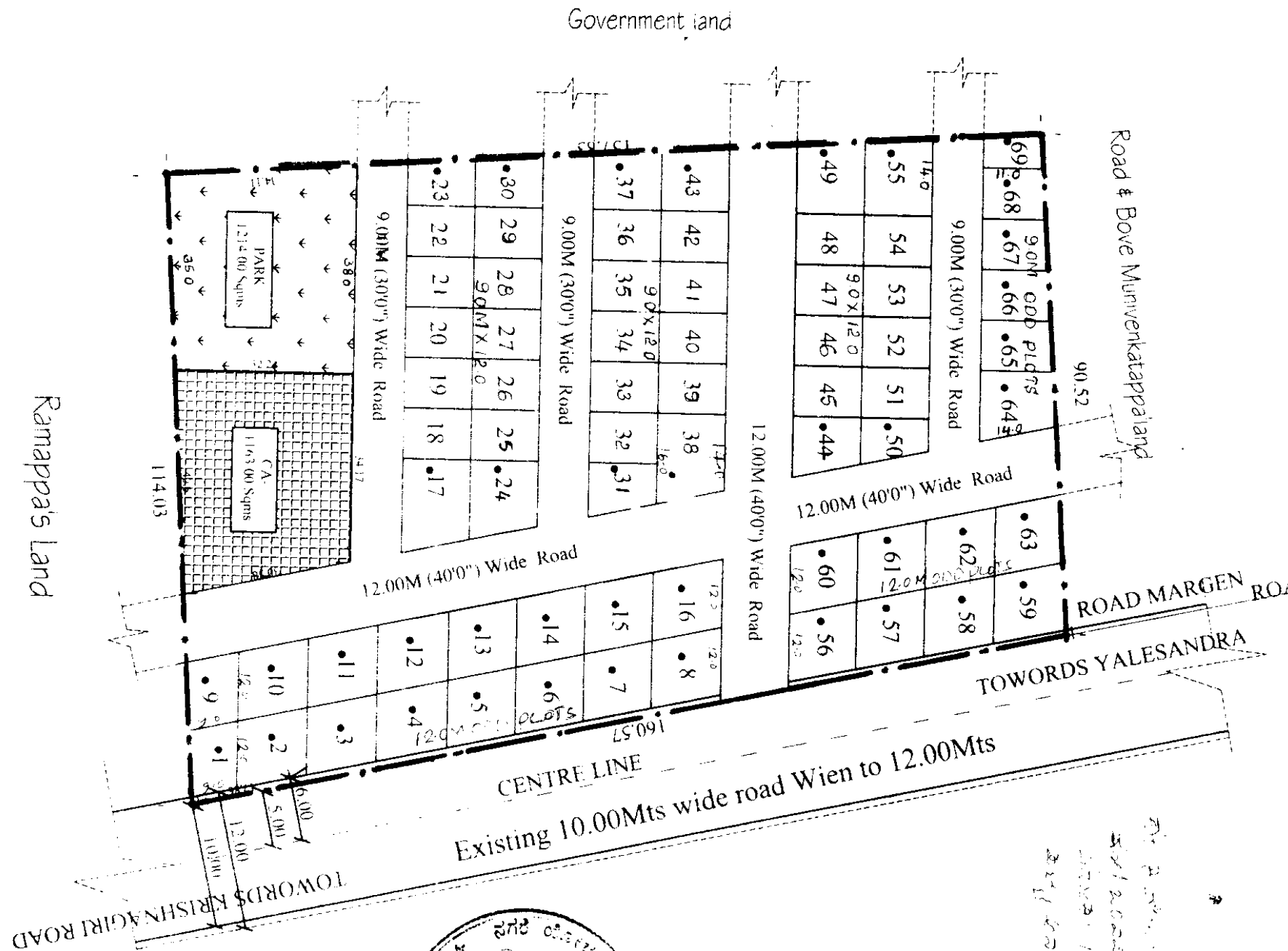

ಶ್ರೀ ಪಂಚಾಂಗ ರೋಡ್ ಬಳಿ ಯೇಸಂದ್ರಾ ಜಿಲ್ಲಾ ಪಂಚಾಯತ್ ಕೆಳಗೆ ಬರುವಂತೆ 16.2 ಹೆಕ್ಟರ್ ಜಮೀನು ಅಧೀನಕ್ಕೆ ತೆಗೆದುಕೊಳ್ಳುವುದಾಗಿ ದೃಢೀಕರಿಸಿ ದಿ. 21/02/2013.

BOUNDARY LINE
 TOTAL EXTENT OF LAND 4A-0 GUNTAS (1.62 HECT)
 DC CONVERSION ORDER NO:ANSR.262/2012-13. DATED 21/02/2013.

| LAND USE ANALYSIS | | |
|-------------------|-----------------|-------------|
| AREA SMT | % | |
| 1. Residential | 8857.00 | 54.70% |
| 2. Road-- | 4959.00 | 30.62% |
| 3. Park-- | 1214.00 | 7.50% |
| 4. C.A.-- | 1163.00 | 7.18% |
| TOTAL | 16193.00 | 100% |

SITE DETAILS
 1. 9.00 X 12.00 M - 27 NOS
 2. . ODD SITES - 42 NOS
 TOTAL NOS OF SITES - 69 NOS

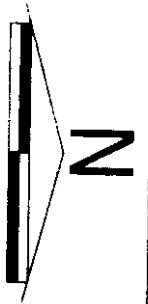

GOVT OF KARNATAKA
 Office Of The Assistant Director
 Department Of Town & Country Planning
 Kolar

ಶ್ರೀ ಪಂಚಾಂಗ ರೋಡ್ ಬಳಿ ಯೇಸಂದ್ರಾ ಜಿಲ್ಲಾ ಪಂಚಾಯತ್ ಕೆಳಗೆ ಬರುವಂತೆ 16.2 ಹೆಕ್ಟರ್ ಜಮೀನು ಅಧೀನಕ್ಕೆ ತೆಗೆದುಕೊಳ್ಳುವುದಾಗಿ ದೃಢೀಕರಿಸಿ ದಿ. 21/02/2013.
 ಸಿ.ಐ.ಎಸ್.ಡಿ. ಡಿರೀಕ್ಟರ್
 PROPOSED RESIDENTIAL LAYOUT AT SY.NO: 89,
 OF YALESANDRA VILAGE OF BUDKOTE HOBLI,
 BANGARAPET TALUK, KOLAR DIST.
 IN FAVOUR OF :
 SRI VASQUEM P.V.
 S/O Anwar par...

TITLE
 SCALE - 1:1000
 DATE 1-06-13
 DWG. NO: 02

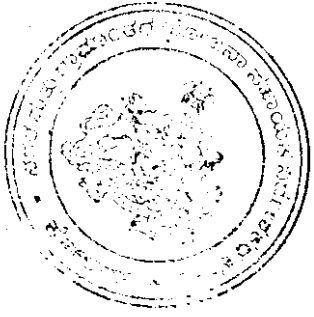

ಕರ್ನಾಟಕ ಸರ್ಕಾರದ ಸರ್ಕಾರಿ ನಡವಳಿ ಸಂಖ್ಯೆ: 2015-16-10005/9-2014
 ತುಮಟ್ಟರಿ ಗ್ರಾಮೀಣ ಪಂಚಾಯತ್, ತುಮಟ್ಟರಿ, ಕೋಲಾರ ಜಿಲ್ಲೆ, ಕರ್ನಾಟಕ
 ದಿನಾಂಕ: 11/12/2015

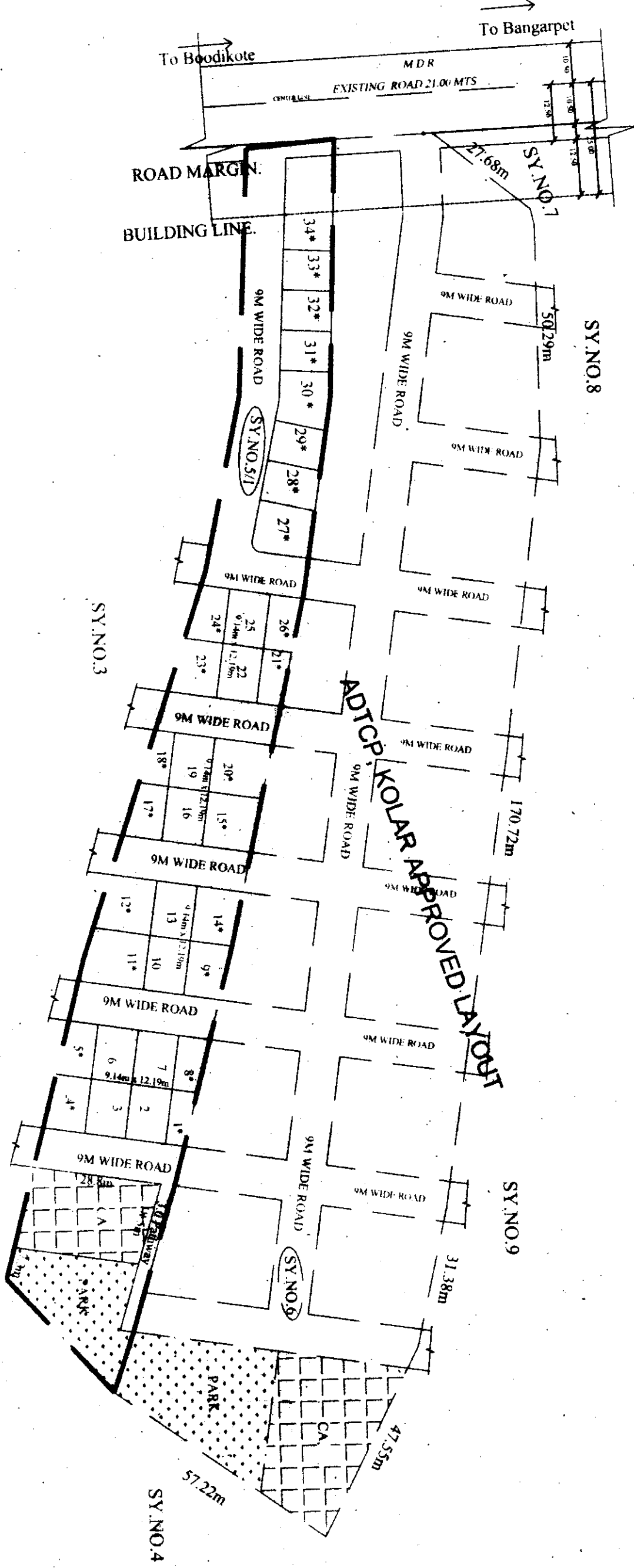

| SI NO | VILLAGE NAME | SY.NO | AREA IN Acres | Area in Guntas | CONVERSION ORDER NUMBER |
|-------|--------------|-------|---------------|----------------|--|
| 1 | TUMATTAGERI | 5/1 | 01 | 30 | ALN/SR(BA)/27/15-16 DATE:11/12/2015 |
| TOTAL | | | 01 | 30 | |

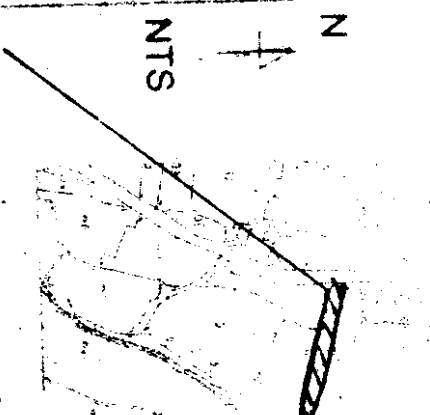

PROPOSED AREA

AREA STATEN
 TOTAL EXTENT : 0.70

RESIDENTIAL LAND USE

LAND USE AREA IN S

RESIDENTIAL 3.829

PARKS 516

CA 519

ROAD 2.215

TOTAL 7.081

| SL NO | RESIDENTIAL PLOT | AREA IN S |
|-------|------------------|-----------|
| 1 | 9.14m x 12.19m | 110.5 |
| 2 | ODD SITES* | 1.0 |
| TOTAL | | 111.5 |

Scale 1:1000

DEPARTMENT OF TOWN & COUNTRY PLANNING
 GOVERNMENT OF KARNATAKA
 Office of the Assistant Director of Town & Country Planning, Kolar District

TITLE: RESIDENTIAL LAYOUT
 SY No 5/1 of TUMATTAGERI
 KASABY H. GILLI BAN
 TOTAL EXTENT : 0.70
 DATE: 11/12/2015

Signature and stamp of the Assistant Director of Town & Country Planning, Kolar District.